

4740/4741 Series Duplex Filters



M&E4740/41EN

Supralon™ lube & hydraulic oil filters deliver consistent, high level fluid system protection across all applications, regardless of severity. Supralon filters feature $\text{Beta}_{X(C)} > 2000$ filter efficiency, low pressure drop and long service life.

Features

- Flows to 340 lpm (90 US gpm)
- Pressures to 450 bar (6500 psi)
- Port size: 1 1/2"

Notes and Specifications Filter Housing

Fatigue Pressure Rating: 400 bar (5800 psi) per NFPA T2.6.1 R2-2001 Cat C/90

Typical Burst Pressure: 1,600 bar (23,200 psi)

Filter Element Collapse Pressure:
20 bard (290 psid) – 4740 series
207 bard (3000 psid) – 4741 series

Fluid Compatibility: Compatible with all petroleum oils and most water glycols, water-oil emulsions, and synthetic hydraulic and lubricating fluids

Temperature Range: -29°C to 120°C (-20°F to 250°F)
60°C (140°F) maximum in HWCF or water glycol

Bypass Valve Setting: 3.4 bard (50 psid) – 4740 series
Non-bypass – 4741 series

Indicator Pressure Setting: 2.4 bard (35 psid) – 4740 series
7 bard (100 psid) – 4741 series

Housing Materials of Construction: Ductile iron head; steel bowl

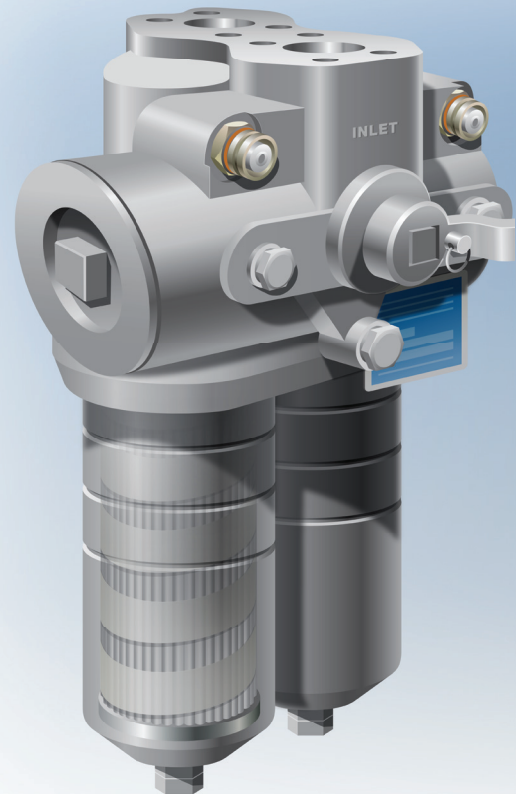

4740 series filter housing

Pressure Drop Information

Housing pressure drop using fluid with 0.9 S.G.
Housing pressure drop is directly proportional to specific gravity.

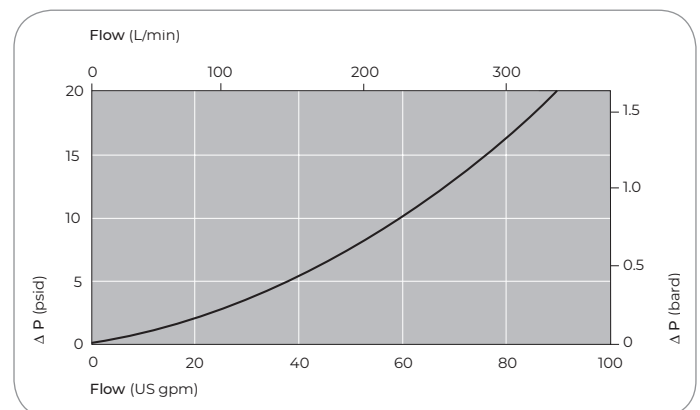

Element Pressure Drop

Multiply actual flow rate times factor in table below to determine pressure drop with fluid at 32 cSt (150 SUS), 0.9 S.G. Correct for other fluids by multiplying new viscosity in cSt/32 (SUS/150) x new S.G./0.9.

9600 Series Element DP Factors (psid/US gpm)

Length	RZ	RP	RN	RS	RT
8"	0.46	0.20	0.17	0.12	0.09
13"	0.27	0.12	0.10	0.07	0.05
16"	0.20	0.09	0.07	0.05	0.04

9601 Series Element DP Factors (psid/gpm)

Length	HP	HS	HT
8"	0.52	0.30	0.12
13"	0.32	0.18	0.08
16"	0.25	0.14	0.07

Dimensional Drawings

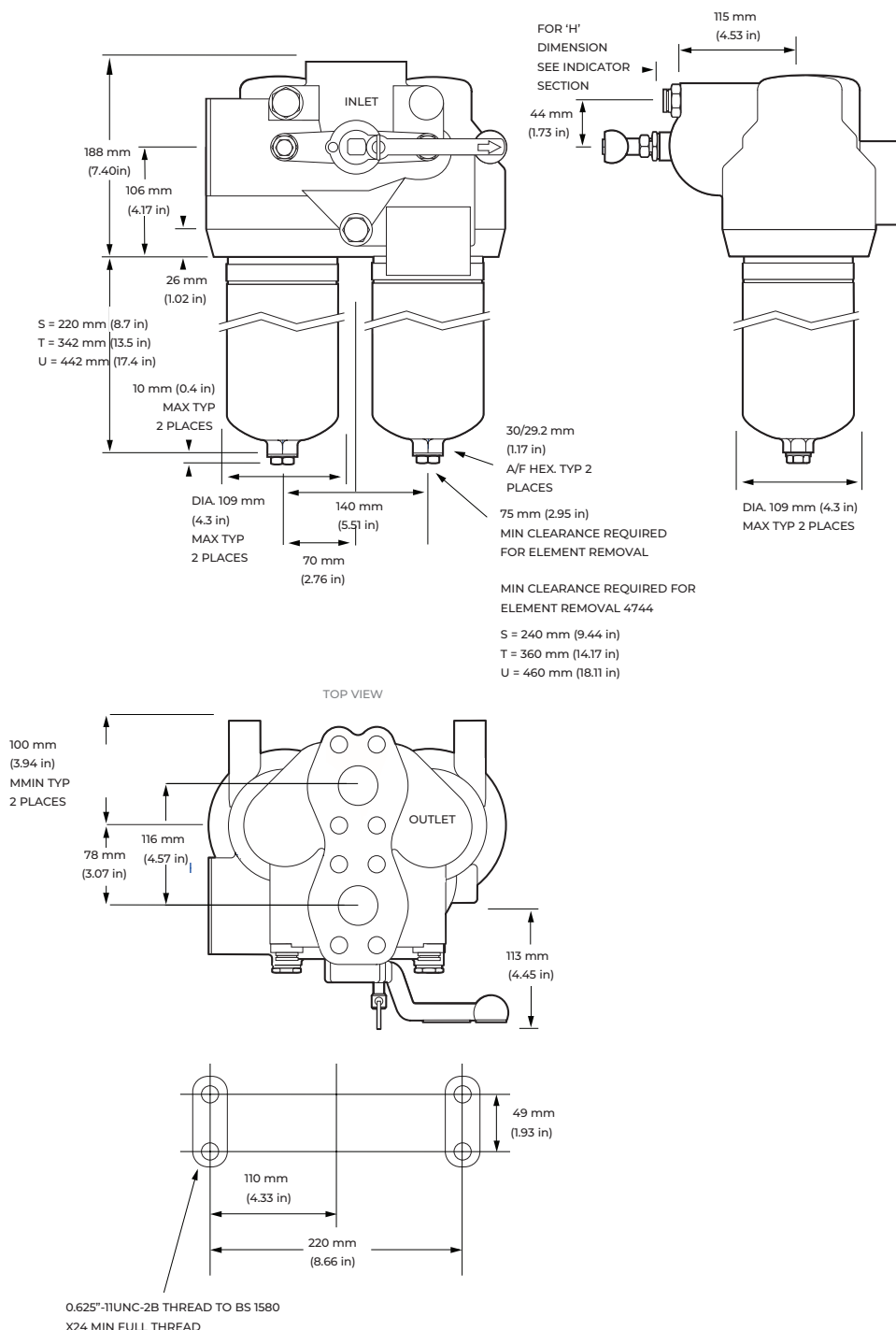

Ordering Information

For new installations, select one complete part number from each section below

Section 1 Housing P/N:

Note: Pall filter housings are supplied without filter elements or filter change out warning devices. Never operate the filter housing unless a filter element is fitted and all warning device ports are sealed.

Housing part number designates indicator port is fitted with a plastic shipping plug.

Part Number

HZ4740C24SB1	HZ4741C24SW1
HZ4740C24TB1	HZ4741C24TW1
HZ4740C24UB1	HZ4741C24UW1
HZ4740G24SB1	HH4741G24TW1
HZ4740G24TB1	HH4741G24UW1
HZ4740G24UB1	

Part Number (Description) Breakdown

HZ	Housing with fluorocarbon seals
4740	4740 series housing
4741	4741 series housing (high collapse element)
C24	1 1/2" BSP ISO 228 threads
G24	1 1/2" ISO 6162 split flange ports (400 bar/5800 psi max pressure)
S	8" nominal length
T	13" nominal length
U	16" nominal length
W	Non-bypass
1	1 indicator warning device port

Section 2 Element P/N:

HC96 1 F 2 3 Z

Table 1: Element Options

Code	Description
00	20 bard (290 psid) – for 4740 series
01	207 bard (3000 psid) – for 4741 series

Table 2: 9600 Series Filter Performance Ratings

Supralon Filter Grade	$\beta_{x(c)} \geq 2000$ based on ISO 16889	ISO Code Rating per Stress-Resistance Test (80% Δp)*
RZ	3	10/08/03
RP	5	12/09/07
RN	7	14/11/06
RS	12	15/11/06
RT	22	16/14/08

Table 2: 9601 Series Filter Performance Ratings

Code	$\beta_{x(c)} \geq 2000$ based on ISO 16889
HP	5
HS	12
HT	15

Table 3: Length Options

Code	Description
8	8" nominal length
13	13" nominal length
16	16" nominal length

Section 3

Differential Pressure Indicator P/N:

RC 4 Z 097 Z 5

Note: If no Differential Pressure Indicator is selected, 'B' type blanking plug (P/N HC9000A104Z) must be ordered separately and fitted to replace the shipping plug.

Note: Z indicates fluorocarbon seals are standard. Other options are available; contact Pall.

Table 4: Indicator Options

Code	Brass Option Indicator
A218M	Electrical switch (SPDT) with Hirschmann connector
A218R	Electrical switch (SPDT) with Hirschmann connector with Red and Green LED indicators
A219D	Visual indicator

Table 4: Indicator Options

Code	Stainless Steel Option Indicator
778N	Visual filter with thermal lockout
861C	Electrical switch (SPDT) with Hirschmann connector
771B	Electrical switch (SPDT) with 3-pin

Table 5: Differential Pressure Indicator Material

Code	Description
Omit	If Brass Indicator is selected in Table 4
SS	If Stainless Steel Indicator is selected in Table 4 (recommended for high pressure applications with pressure > 200 bar (3000 psi))

The equipment has been assessed in accordance with the guidelines laid down in The European Pressure Directive 97/23/EC and has been classified within Sound Engineering Practice S.E.P. Suitable for use with Group 1 and 2 fluids only. Consult Sales for other fluid gas group suitability.



PALL CORPORATION

Corporate Headquarters

Port Washington, NY, USA
+1-800-717-7255 toll free (USA)
+1-516-484-5400 phone

European Headquarters

Fribourg, Switzerland
+41 (0)26 350 53 00 phone

Asia-Pacific Headquarters

Singapore
+65 6389 6500 phone

Visit us on the Web at www.pall.com/industry

Contact us at www.pall.com/contact

Pall Corporation has offices and plants throughout the world. To locate the Pall office or distributor nearest you, visit www.pall.com/contact.

The information provided in this literature was reviewed for accuracy at the time of publication. Product data may be subject to change without notice. For current information consult your local Pall distributor or contact Pall directly.

IF APPLICABLE Please contact Pall Corporation to verify that the product conforms to your national legislation and/or regional regulatory requirements for water and food contact use.

© Copyright 2022, Pall Corporation. Pall,  and Supralon are trademarks of Pall Corporation.
® Indicates a trademark registered in the USA.

M&E4740/41EN
February 2022