

Modern heavy duty diesel engines are highly susceptible to damage from particulate contamination in diesel fuel while water contamination can reduce efficiency and accelerate wear. The result, if left unchecked, is reduced reliability of critical equipment, unscheduled downtime and an increase in maintenance and repair costs.

**Ultipleat Diesel Plus filters provide advanced particulate and water removal from diesel fuel within a single filter element.**

- Extend time between scheduled maintenance periods
- Keep equipment in service longer
- Increase reliability of equipment and mean time between failures (MTBF)
- Single filter solution to remove dirt and water
- Simple to install and service

The Ultipleat Diesel Plus Fuel filter housing and filter element range features:

- Filter element with integral high performance coalescer to rapidly remove free water
- Single-pass particulate contamination removal down to ISO 4406 code 13/12/11
- Low differential pressure drop throughout the full service life of the filter element
- Stress resistant filter media design
- Stainless steel filter housing construction
- Simple element change out procedure

### Product Specifications

Flow Range:	190 – 1325 L/min (50 – 350 US gpm)
Max. Pressure Rating:	10 barg (150 psig)
Temperature:	-29 °C to 50 °C (-20 °F to 122 °F)
Filter Rating:	5µm ( $\beta_{x(5)} \geq 1000$ per ISO 16889)
Coalescer water removal rating:	<50ppm Free Water @ 15 dyn/cm & 50gpm
Filter element length:	40" nominal

## New: Ultipleat™ Diesel Plus Filters

Particulate and water removal in a single element

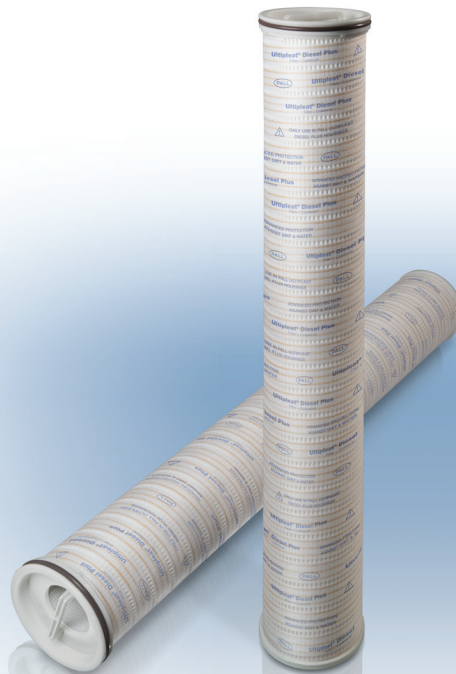

*Ultipleat Diesel Plus Filter*

In comparative tests, the number of Ultipleat Diesel Plus filters elements required was significantly less compared to existing Pall or alternative solutions, resulting in an overall reduction in operating costs.

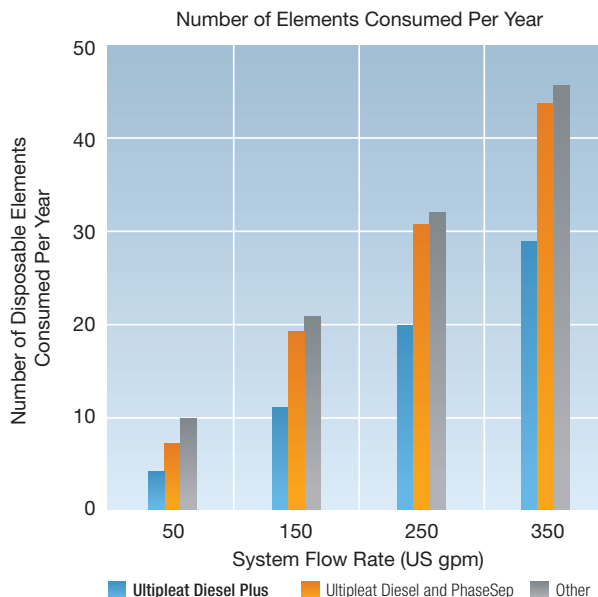

**Save Time  
Reduce Cost  
Increase Reliability**

## Overall Equipment Effectiveness

Contaminated fuel has the potential to impact several key performance indicators which affect Overall Equipment Effectiveness (OEE).

- Equipment breakdowns caused by fuel injectors fouling or increased fuel pump wear
- Shortened or inconsistent service intervals increasing maintenance costs
- Reduced equipment performance, resulting in extended process time and greater fuel consumption

Several of the largest mining companies closely monitor OEE as a gauge of the profitability of a mine. If measures are taken to improve the OEE, such as efforts to reduce contaminants in fuel, it can have a serious impact on the economic success of a mining company.

## Housing Ordering Information





Part Number	No. of Filter Elements	Port Size	Dimensions				Minimum Service Clearance mm (in)	Dry Weight Kg (lbs)	Volume L (US Gal)
			A mm (in)	B mm (in)	C mm (in)	D mm (in)			
UDPV1 	1	2" 150# ANSI RFSO	2076 (81.7)	273 (10.75)	802 (31.6)	1818 (71.6)	3024 (119.1)	140 (308)	75 (19.8)
UDPV3 	3	3" 150# ANSI RFSO	2520 (99.2)	610 (24.0)	817 (32.17)	1833 (72.17)	3090 (121.67)	492 (1085)	560 (148)
UDPV5 	5	6" 150# ANSI RFSO	2706 (106.5)	712 (28)	915 (36)	1931 (76)	3221 (126.8)	650 (1433)	850 (224.6)
UDPV7 	7	6" 150# ANSI RFSO	2779 (109.4)	812 (32)	934 (39.1)	1950 (79.1)	3274 (128.9)	765 (1686)	1010 (266.8)

Table 1: Design Options

Code	Option
A	ASME Section VIII Div 1
C	CSA-B51-97 Canadian Standard
E	In accordance with PED
G	In accordance with GB150

### Water Separator Ordering Information

<b>UDPS</b>	Water Separator
-------------	-----------------

Note: must order water separator with housing

### Element Ordering Information

<b>UDPEJP</b>	5 µm Particulate/Water removal element
---------------	--

Other ratings available on application

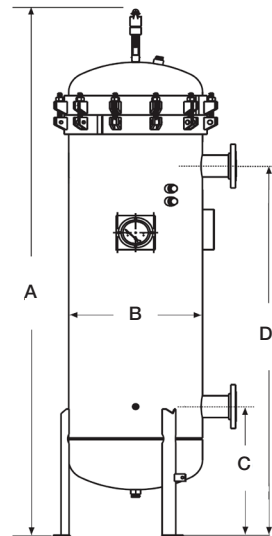

**Pall Corporation**

Pall Machinery and Equipment

25 Harbor Park Drive  
Port Washington, NY 11050  
+1 516 484 3600 telephone  
+1 800 289 7255 toll free US

Portsmouth - UK  
+44 (0)23 9233 8000 telephone  
+44 (0)23 9233 8811 fax  
industrialeu@pall.com



Visit us on the Web at [www.pall.com](http://www.pall.com)

Pall Corporation has offices and plants throughout the world. For Pall representatives in your area, please go to [www.pall.com/contact](http://www.pall.com/contact)

Because of technological developments related to the products, systems, and/or services described herein, the data and procedures are subject to change without notice. Please consult your Pall representative or visit [www.pall.com](http://www.pall.com) to verify that this information remains valid.

© Copyright 2016, Pall Corporation. Pall, (PALL) and Ultipleat are trademarks of Pall Corporation. ® Indicates a trademark registered in the USA. Better Lives. Better Planet and Filtration. Separation. Solution.sm are service marks of Pall Corporation.